



- State-of-the-art LED technology with high luminous efficacy and long service life
- Extremely high luminaire efficacy
- Can be adjusted from a 1.5 to a 3.0 h rated operating time
- Luminous flux after 100,000 h still 90% of the starting luminous flux
- Optionally with DALI for controlling and monitoring the light fitting
- Automatic weekly functional test and annual rated operating time test

## MY R. STAHL 6009D



The emergency luminaire with Series 6009/4 LED with integrated battery can be installed in stand-by switching, continuous mode or in switchable stand-by switching. A weekly functional test and annual rated operating time test are performed automatically. The results are indicated by an LED.

## Technical Data

## Explosion Protection

|                                 |   |
|---------------------------------|---|
| Ex version                      | Yes   |
| Application range (zones)       | 1, 2, 21, 22                                |
| IECEX gas certificate           | IECEX IBE 16.0038                           |
| IECEX gas certificate           | IECEX IBE 16.0038                           |
| IECEX gas explosion protection  | Ex db eb ib op is IIC T4 Gb                 |
| IECEX dust certificate          | IECEX IBE 16.0038                           |
| IECEX dust explosion protection | Ex tb op is IIIC T100 °C Db                 |
| ATEX gas certificate            | IBExU 16 ATEX 1199                          |
| ATEX gas certificate            | IBExU 16 ATEX 1199                          |
| ATEX gas explosion protection   | Ex II 2 G Ex db eb ib op is IIC T4 Gb       |
| ATEX dust certificate           | IBExU 16 ATEX 1199                          |
| ATEX dust explosion protection  | Ex II 2 D Ex tb op is IIIC T100 °C Db       |
| Certificates and approvals      | ATEX<br>IECEX                               |
| Certificates                    | ATEX (IBE), IECEX (IBE), India (PESO)       |
| Ship approval                   | DNV   |
| Declaration of conformity       | ATEX (EUK), Declaration of Conformity (AUS) |

## Electrical Data

|                              |                         |
|------------------------------|-------------------------|
| Rated operational voltage AC | 100 ... 240 V           |
| Battery version              | NiCd battery, gas-tight |
| Battery operating voltage    | 6 V                     |
| Battery capacity             | 7 Ah                    |
| Self-test function           | With (standard)         |
| Frequency range              | 50 – 60 Hz              |

## Lighting Data

|                 |      |
|-----------------|------|
| Number of lamps | 1    |
| Lamp wattage    | 25 W |
| Lamp            | LED  |

#### Lighting Data

|                        |                                       |
|------------------------|---------------------------------------|
| Light colour           | 6500 K – daylight white               |
| Light distribution     | 120°x120° with diffusing glass        |
| Luminaire efficacy     | 116 lm/W                              |
| Luminous flux          | 2910 lm                               |
| Operating time         | 1.5 / 3h emergency lighting operation |
| Emergency light output | 35% – 3 h<br>65% – 1.5 h              |
| Colour rendering       | ≥ 80                                  |
| Colour temperature     | 6500 K                                |

#### Ambient Conditions

|                     |  |
|---------------------|--|
| Ambient temperature | -30 °C ... +50 °C Note: Through wiring Max. 3x16 A<br>-30 °C ... +55 °C Note: Through wiring 2 Max. 3x10 A |
|---------------------|--|

#### Mechanical Data

|   |   |
|---|---|
| Version                                   | Standard                                |
| IP degree of protection (IEC 60598)       | IP66/IP67                               |
| Enclosure material                        | Polyester resin, Glass fibre reinforced |
| Enclosure colour                          | Light grey (RAL 7035)                   |
| Diffuser                                  | With diffuser                           |
| Sealing material                          | Silicone                                |
| Silicone-free content                     | Contains silicone                       |
| Translucent cover material                | Polycarbonate                           |
| Installed terminal strip                  | PE + N + L1 + L2 + L3 + L´              |
| Max. solid connection terminals           | 6 mm²                                   |
| Max. finely stranded connection terminals | 4 mm²                                   |
| Type of connection cable                  | Solid<br>Finely stranded                |
| Size                                      | 2                                       |
| Width                                     | 183.5 mm                                |
| Height                                    | 125 mm                                  |
| Length                                    | 857 mm                                  |
| Impact strength (IEC 62262)               | IK10                                    |
| Weight                                    | 6.7 kg                                  |
| Weight                                    | 14.77 lb                                |
| Disconnection of the luminaire            | All-pole disconnection                  |

#### Components

|                          |                                |
|--------------------------|--------------------------------|
| Threaded plate           | 2x SS430 stainless steel       |
| Ballast                  | 6046/311-121-010               |
| Through wiring           | With 6 conductors 2.5 mm²      |
| Drilled holes            | 3 x M20                        |
| Cable glands and entries | can be ordered as an accessory |
| Stopping plugs           | Can be ordered as accessories  |
| Accessories              | without                        |

#### Dimensional Drawings (All Dimensions in mm [inches]) – Subject to Alterations

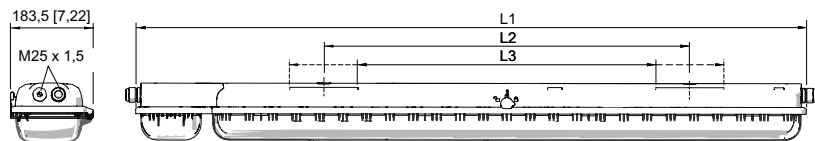

Size 2:  
L1 = 857 mm [33.74]  
L2 = 400 mm [15.75]  
L3 = 320 ... 480 mm [12.60 ... 18.90]

Size 4:  
L1 = 1467 mm [57.76]  
L2 = 800 mm [31.50]  
L3 = 670 ... 930 mm [26.38 ... 36.61]

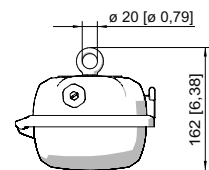
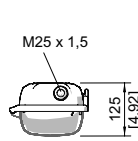

Ring bolt fitted in insert nut of the luminaire

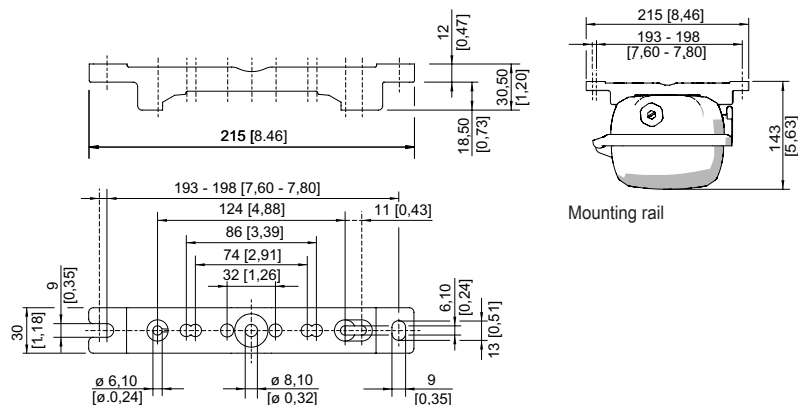

Mounting rail

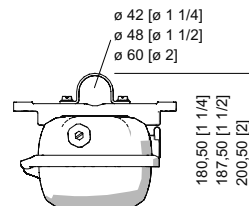

Pipe clamp fitted in mounting rail

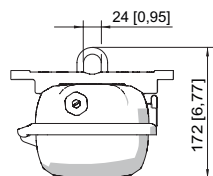

Mounting bracket fitted in mounting rail

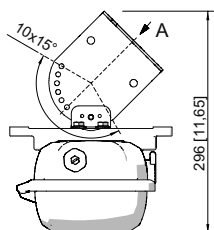

A

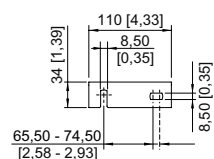

Wall mounting bracket fitted in mounting rail

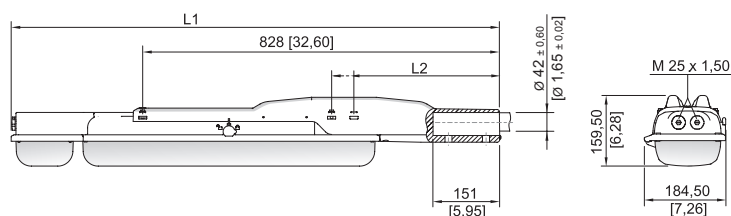

With pole mounting sleeve

Size 2:  
L1 = 1133 mm [44.61]  
L2 = 390 mm [15.35]

Size 4:  
L1 = 1742 mm [68.58]  
L2 = 338 mm [13.31]

## Accessories

# Lighting

## Emergency luminaire With LED

### GRP

6009/4128-2103-162-2220-22-865011 Art. No. 282479

STAHL

#### Breather

#### Art. No.

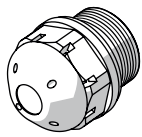

Thread: M25 x 1.5 (20 pieces); without jam nut

285780

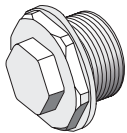

Thread: M25 x 1.5 (1 piece); for installation in light fittings; made from stainless steel; without jam nut

296608

#### Holder for translucent cover

#### Art. No.



The fall prevention system for the light fitting cover prevents the light fitting cover from falling accidentally when the light fitting is opened.

226791

#### Pole mounting sleeve

#### Art. No.



for the subsequent mounting on lights size 2 and size 4, completely with assembly parts (for pipe diameter 42 mm)

227512

#### Protection against accidental contact

#### Art. No.

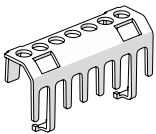

The protection against accidental contact prevents maintenance technicians and electrical installers from accidentally touching conductive parts. The degree of protection is increased to IP20 when the protection against accidental contact is used.

283153

#### Box spanner

#### Art. No.

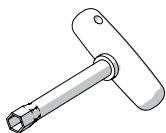

M8 / A/F 13;  
For actuating the central lock

222430

#### Mounting rail

#### Art. No.

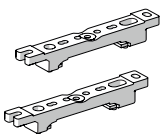

for a variable mounting distance; 1 pair

222826

#### Mounting bracket

#### Art. No.

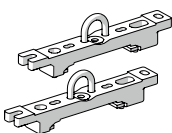

mounting clamp mounted on a mounting rail for a variable mounting distance; 1 pair

222456

#### Pipe clamp

#### Art. No.

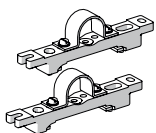

R 1 1/2"; with mounting rail for a variable mounting distance; material: stainless steel; 1 pair

222459

R 1 1/4"; with mounting rail for a variable mounting distance; Material: stainless steel; 1 pair

222458

R 2"; with mounting rail for a variable mounting distance; Material: stainless steel; 1 pair

222460

# Lighting

Emergency luminaire With LED

GRP

6009/4128-2103-162-2220-22-865011 Art. No. 282479

STAHL

## Ring bolt

Art. No.



M8, direct mounting in insert nuts; 1 pair

115736

## Breather

Art. No.

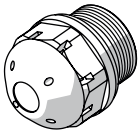

M25 x 1.5 in order to avoid condensate formation

115738

## Ceiling and wall mounting bracket

Art. No.

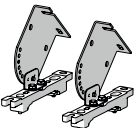

mounted on a mounting rail for a variable mounting distance; Material: stainless steel; Lamp can be swiveled in steps of 15°; 1 pair

222827

## Spare Parts

### Cover

Art. No.

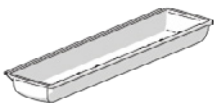

for luminaire size 2

222427

### Contact element

Art. No.

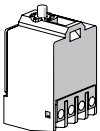

8080/1-3-L 2 NC contact element

132527

### Battery set

Art. No.

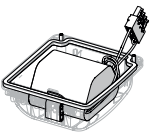

Battery cover with built-in battery. Gas-tight NiCd battery; 7 Ah / 6 V

223532

We reserve the right to make alterations to the technical data, dimensions, weights, designs and products available without notice. The illustrations cannot be considered binding.